

SGLOCKS

Newsletter

MAY/JUN 2023
ISSUE 102



LOCKTON

commercial

**BLACK
RANGE**

NEW

**LOCKTON
BLACK RANGE
LAUNCH**

NEW

**ORIGINAL LISHI
L- DOMESTIC
RANGE**



NEW

MORTICE LOCKS & FURNITURE

Wide (60mm)



NEW



'60mm' Backset MORTICE LOCK *Matte Black*

PRODUCT DESCRIPTION

The LOCKTON 60mm mortice lock body and latch are made from 304 Stainless Steel, making them not only extremely tough and durable, but also extremely weather resistant to the harsh Australian environment.

The LOCKTON Art. SG-ML60-BLK retrofits Australian standard 60mm mortice locks and comes with the required fixing screws, strikes, cylinder retaining pins, turn snib adapter, templates and instructions.

PRODUCT SPECIFICATION

- 'Easy Change' Lock Functions - turn the dial on the side of the lock body (Consistent with the LOCKTON 23mm Backset & 30mm Backset Mortice Locks)
- Kick off function
- Accepts Australian oval cylinder
- Easy close action for electric strikes
- Uses industry standard cams
- 4-hour fire rating
- 5-year warranty
- Cycle tested
- Fits doors between 32-50 mm
- Suits left & right opening doors
- Electric strike compatible.



4- Hour Fire Rating



5 Year Warranty

Art. SG-ML60-BLK

NEW



Standard FACE PLATE (175mm Long) - Suits Art. SG-ML60 *Matte BLACK*

PRODUCT DESCRIPTION

The LOCKTON Art. FPML60-LT175-BLK Standard Face Plate - Black, designed to suit Art. SG-ML60. This Face Plate does not come standard with the Art. SG-ML60.

Used in place of the standard SSS Face Plate when a Black finish is required.

PRODUCT SPECIFICATION

- Dimensions: 175 x 25mm
- Plate Thickness: 2mm
- Material: Satin Stainless Steel
- Finish: Matte Black

Art. FPML60-LT175-BLK

NEW



'Square End' - EXT PLATE - CYL HOLE & LEVER - *Matte BLACK*

PRODUCT SPECIFICATION

- Dimensions (L x W x D): 165 x 46 x 18mm
- Mounting Screw Spacing: 150mm

Art. SQ-01C-25-BLK

NEW



'Square End' - EXT PLATE - CYL HOLE ONLY - *Matte BLACK*

PRODUCT SPECIFICATION

- Dimensions (L x W x D): 165 x 46 x 18mm
- Mounting Screw Spacing: 150mm

Art. SQ-04C-BLK

NEW



'Square End' - EXT PLATE - EMERGENCY TURN & LEVER - *Matte BLACK*

PRODUCT SPECIFICATION

- Dimensions (L x W x D): 165 x 46 x 18mm
- Mounting Screw Spacing: 150mm

Art. SQ-03C-25-BLK

NEW



'Square End' - EXT PLATE - EMERGENCY TURN, INDICATOR & LEVER - *Matte BLACK*

PRODUCT SPECIFICATION

- Dimensions (L x W x D): 165 x 46 x 18mm
- Mounting Screw Spacing: 150mm

Art. SQ-53C-25-BLK

NEW



'Square End' - EXT PLATE - LEVER ONLY - *Matte BLACK*

PRODUCT SPECIFICATION

- Dimensions (L x W x D): 165 x 46 x 18mm
- Mounting Screw Spacing: 150mm

Art. SQ-02C-25-BLK

NEW



'Square End' - INT PLATE - CYL HOLE & LEVER - *Matte BLACK*

PRODUCT SPECIFICATION

- Dimensions (L x W x D): 165 x 46 x 18mm
- Mounting Screw Spacing: 150mm

Art. SQ-01V-25-BLK

NEW



'Square End' - INT PLATE - CYL HOLE ONLY - *Matte BLACK*

PRODUCT SPECIFICATION

- Dimensions (L x W x D): 165 x 46 x 18mm
- Mounting Screw Spacing: 150mm

Art. SQ-04V-BLK

NEW



'Square End' - INT PLATE - LEVER ONLY - *Matte BLACK*

PRODUCT SPECIFICATION

- Dimensions (L x W x D): 165 x 46 x 18mm
- Mounting Screw Spacing: 150mm

Art. SQ-02V-25-BLK

NEW



'Square End' - INT PLATE - SNIB & LEVER - *Matte BLACK*

PRODUCT SPECIFICATION

- Dimensions (L x W x D): 165 x 46 x 18mm
- Mounting Screw Spacing: 150mm

Art. SQ-13V-25-BLK

NEW



'Square End' - INTERNAL PLATE - DA TURN SNIB & LEVER - *Matte BLACK*

PRODUCT SPECIFICATION

- Dimensions (L x W x D): 165 x 46 x 18mm
- Mounting Screw Spacing: 150mm

Art ID: SQ-13VDA-25-BLK

NEW



'Square End' - INTERNAL PLATE - DA TURN SNIB ONLY - *Matte BLACK*

PRODUCT SPECIFICATION

- Dimensions (L x W x D): 165 x 46 x 18mm
- Mounting Screw Spacing: 150mm

Art. SQ-06VDA-BLK



4- Hour Fire Rating



5 Year Warranty

NEW

MORTICE LOCKS & FURNITURE

Wide (60mm) Kits



NEW



'60mm' Mortice Lock KIT1 (CLASSROOM) - Inc. Lock, Furniture & Cylinder *Matte Black*

PRODUCT DESCRIPTION

- The LOCKTON 60mm Mortice Lock KIT 1 (CLASSROOM) contains a LOCKTON 60mm Backset Mortice Lock, Oval Cylinder and suitable furniture.

Kit contains:

- 1 x 60mm Mortice Lock (Art. SG-ML60-BLK)
- 1 x External Lever with Cylinder Hole (Art. SQ-01C-25-BLK)
- 1 x Internal Lever Only (Art. SQ-02V-25-BLK)
- 1 x Oval Cylinder (Art. 410-BLK-KD)

PRODUCT SPECIFICATION

- 'Easy Change' Lock Functions - turn the dial on the side of the lock body (Consistent with the LOCKTON 23mm Backset & 30mm Backset Mortice Locks)
- Accepts Australian oval cylinder
- Easy close action for electric strikes
- Uses industry standard cams
- 4-hour fire rating
- 5-year warranty
- Cycle tested
- Fits doors between 32-50 mm
- Suits left & right opening doors
- Electric strike compatible



4- Hour Fire Rating



5 Year Warranty

Art. ML60-KIT1-BLK

NEW



'60mm' Mortice Lock KIT2 (ENTRANCE) - Inc. Lock, Furniture & Cylinder *Matte Black*

PRODUCT DESCRIPTION

- The LOCKTON 60mm Mortice Lock KIT 2 (ENTRANCE) contains a LOCKTON 60mm Backset Mortice Lock, Oval Cylinder and suitable furniture.

Kit contains:

- 1 x 60mm Mortice Lock (Art. SG-ML60-BLK)
- 1 x External Lever with Cylinder Hole (Art. SQ-01C-25-BLK)
- 1 x Internal Lever with Turn-Snib (Art. SQ-13V-25-BLK)
- 1 x Oval Cylinder (Art. 410-BLK-KD)

PRODUCT SPECIFICATION

- 'Easy Change' Lock Functions - turn the dial on the side of the lock body (Consistent with the LOCKTON 23mm Backset & 30mm Backset Mortice Locks)
- Accepts Australian oval cylinder
- Easy close action for electric strikes
- Uses industry standard cams
- 4-hour fire rating
- 5-year warranty
- Cycle tested
- Fits doors between 32-50 mm
- Suits left & right opening doors
- Electric strike compatible



4- Hour Fire Rating

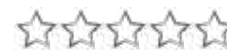

5 Year Warranty

Art. ML60-KIT2-BLK

NEW

MORTICE LOCKS & FURNITURE

Narrow Stile



NEW



23mm Backset MORTICE LOCK *Matte Black*

PRODUCT DESCRIPTION

- The LOCKTON Art. SG-SBML23-BLK Narrow Stile Mortice Lock Black (23mm Backset).
- Retrofits most Australian 23mm Backset Latching Mortice Locks
- Accepts Australian Oval Cylinders
- Includes Turn Snib Adapter, Fixing Screws, Strike Plate and Instructions
- Easy Close Action for Electric Strikes
- Uses Industry Standard Cams
- Electric Strike Compatible
- 5 Year Warranty

PRODUCT SPECIFICATION

- Latch: Stainless Steel (Reversible)
- Mortice Lock (Body ONLY) is 38.5mm deep, this does NOT include the face plate.

Supplied with the following

- 1 x Art. FPSBML-LT155-BLK Face Plate
- 1 x Art. STSBML-STD-BLK Strike



4- Hour
Fire Rating
5 Year
Warranty



Art. SG-SBML23-BLK

NEW



30mm Backset MORTICE LOCK *Matte Black*

PRODUCT DESCRIPTION

- The LOCKTON Art. SG-SBML30-BLK Narrow Stile Mortice Lock Black (30mm Backset).
- Retrofits most Australian 30mm Backset Latching Mortice Locks
- Accepts Australian Oval Cylinders
- Includes Turn Snib Adapter, Fixing Screws, Strike Plate and Instructions
- Easy Close Action for Electric Strikes
- Uses Industry Standard Cams
- Electric Strike Compatible
- 5 Year Warranty

PRODUCT SPECIFICATION

Latch: Stainless Steel (Reversible)

Supplied with the following

- 1 x Art. FPSBML-LT155-BLK Face Plate
- 1 x Art. STSBML-STD-BLK Strike



4- Hour
Fire Rating
5 Year
Warranty



Art. SG-SBML30-BLK

NEW

MORTICE LOCKS & FURNITURE

Narrow Stile Kits



Mortice Lock KIT1 (CLASSROOM) - Inc. Lock, Furniture & Cylinder *Matte Black*

PRODUCT DESCRIPTION

Suitable furniture for use in "Classroom" configuration. Can be ordered in 23mm or 30mm Backset.



4- Hour Fire Rating



5 Year Warranty

Kit contains:

- 1 x 23mm Narrow Stile Mortice Lock (Art. SG-SBML23-BLK) **or**
- 1 x 30mm Narrow Stile Mortice Lock (Art. SG-SBML30-BLK)
- 1 x External Lever with Cylinder Hole (Art. NSQ-01C-25-BLK)
- 1 x Internal Lever Only (Art. NSQ-02V-25-BLK)
- 1 x Oval Cylinder (Art. 410-BLK-KD)

PRODUCT SPECIFICATION

- Retrofits most Narrow Stile Latching Mortice Locks & Furniture
- Accepts Australian Oval Cylinder, Includes LOCKTON KD Oval Cylinder
- Stainless Steel reversible Latch
- Easy close action for Electric Strikes
- Uses industry standard Cams
- Includes Turn-Snib Adaptor, Fixing Screws, Strike Plate & Instructions

Art. SBML23-KIT1-BLK
(for 23mm Mortice Lock)

Art. SBML30-KIT1-BLK
(for 30mm Mortice Lock)



Mortice Lock KIT2 (ENTRANCE) - Inc. Lock, Furniture & Cylinder *Matte Black*

PRODUCT DESCRIPTION

Suitable furniture for use in "Entrance" configuration. Can be ordered in 23mm or 30mm Backset.



4- Hour Fire Rating



5 Year Warranty

Kit contains:

- 1 x 23mm Narrow Stile Mortice Lock (Art. SG-SBML23-BLK) **or**
- 1 x 30mm Narrow Stile Mortice Lock (Art. SG-SBML30-BLK)
- 1 x External Lever with Cylinder Hole (Art. NSQ-01C-25-BLK)
- 1 x Internal Lever with Turn-Snib (Art. NSQ-13V-25-BLK)
- 1 x Oval Cylinder (Art. 410-BLK-KD)

PRODUCT SPECIFICATION

- Retrofits most Australian Narrow Stile Latching Mortice Locks & Furniture
- Accepts Australian Oval Cylinder, Includes LOCKTON KD Oval Cylinder
- Stainless Steel reversible Latch
- Easy close action for Electric Strikes
- Uses industry standard Cams
- Includes Turn-Snib Adaptor, Fixing Screws, Strike Plate & Instructions

Art. SBML23-KIT2-BLK
(for 23mm Mortice Lock)

Art. SBML30-KIT2-BLK
(for 30mm Mortice Lock)



4- Hour Fire Rating



5 Year Warranty

Narrow stile Mortice Lock Range

NEW



Art. NSQ-01C-25-BLK

Narrow Stile - Sq. End - EXT PLATE - CYL HOLE & LEVER - *Matte BLACK*

PRODUCT SPECIFICATION

- Dimensions (L x W x D): 185 x 25 x 14mm
- Mounting Screw Spacing: 160mm
- End Type: Square

NEW



Art. NSQ-04C-BLK

Narrow Stile - Sq. End - EXT PLATE - CYL HOLE ONLY - *Matte BLACK*

PRODUCT SPECIFICATION

- Dimensions (L x W x D): 185 x 25 x 14mm
- Mounting Screw Spacing: 160mm
- End Type: Square

NEW



Art. NSQ-02C-25-BLK

Narrow Stile - Sq. End - EXT PLATE - LEVER ONLY - *Matte BLACK*

PRODUCT SPECIFICATION

- Dimensions (L x W x D): 185 x 25 x 14mm
- Mounting Screw Spacing: 160mm
- End Type: Square

NEW



Art. NSQ-01V-25-BLK

Narrow Stile - Sq. End - INT PLATE - CYL HOLE & LEVER - *Matte BLACK*

PRODUCT SPECIFICATION

- Dimensions (L x W x D): 185 x 25 x 14mm
- Mounting Screw Spacing: 160mm
- End Type: Square

NEW



Art. NSQ-04V-BLK

Narrow Stile - Sq. End - INT PLATE - CYL HOLE ONLY - *Matte BLACK*

PRODUCT SPECIFICATION

- Dimensions (L x W x D): 185 x 25 x 14mm
- Mounting Screw Spacing: 160mm
- End Type: Square

NEW



Art. NSQ-13VDA-25-BLK

Narrow Stile - Sq. End - INT PLATE - DA SNIB & LEVER - *Matte BLACK*

PRODUCT SPECIFICATION

- Dimensions (L x W x D): 185 x 25 x 14mm
- Mounting Screw Spacing: 160mm
- End Type: Square

NEW



Art. NSQ-02V-25-BLK

Narrow Stile - Sq. End - INT PLATE - LEVER ONLY - *Matte BLACK*

PRODUCT SPECIFICATION

- Dimensions (L x W x D): 185 x 25 x 14mm
- Mounting Screw Spacing: 160mm
- End Type: Square

NEW



Art. NSQ-13V-25-BLK

Narrow Stile - Sq. End - INT PLATE - SNIB & LEVER - *Matte BLACK*

PRODUCT SPECIFICATION

- Dimensions (L x W x D): 185 x 25 x 14mm
- Mounting Screw Spacing: 160mm
- End Type: Square

NEW



Standard FACE PLATE (155mm Long) - Suits Art.: SG-SBML23 & SG-SBML30 *Matte BLACK*

PRODUCT DESCRIPTION

The LOCKTON Art. FPSBML-LT155-BLK Standard Face Plate - Black, designed to suit Art. SG-SBML23 & Art. SG-SBML30.

This Face Plate does not come standard with Art. SG-SBML23 & Art. SG-SBML30. Used in place of the standard SSS Face Plate when Black furniture is required.

PRODUCT SPECIFICATION

- Dimensions: 155 x 25mm
- Plate Thickness: 2mm
- Material: Satin Stainless Steel
- Finish: Matte Black

Art. FPSBML-LT155-BLK

NEW

DOOR CLOSERS



NEW



'160 Series' DOOR CLOSER - Rack & Pinion - (2-4) *MATTE BLACK*

PRODUCT DESCRIPTION

The LOCKTON Art. SGDC160-BLK Rack & Pinion Door Closer w/ Black Finish.

PRODUCT SPECIFICATION

- Rack & Pinion operation
- Non-handed
- Comes with Standard arm
- Parallel Arm Bracket
- Mounting hardware
- Adjustable Backcheck
- Simple to read installation instructions
- Closing range 180° - 15°
- Latching speed range 15° - 0°
- Suitable for door sizes 2-4
- Size #2: Door width of 850mm & Weight of 40kg
- Size #3: Door width of 950mm & weight of 60kg
- Size #4: Door width of 1100mm & Weight of 80kg
- Finish: Matte Black
- 5 year warranty
- Fire Rated AS1905, As1530 (4 Hours)
- Tested & certified to BS EN 1154:1997
- MADE IN TAIWAN



4- Hour
Fire Rating



5 Year
Warranty

Art. SGDC160-BLK



4- Hour
Fire Rating

Door Closers



5 Year
Warranty

NEW

'165 Series' DOOR CLOSER - Rack & Pinion - (2-6) * MATTE BLACK*



PRODUCT SPECIFICATION

- Rack & Pinion operation
- Non-handed
- Comes with Standard arm
- Parallel Arm Bracket
- Mounting hardware
- Adjustable Backcheck
- Simple to read installation instructions
- Closing range 180° - 15°
- Latching speed range 15° - 0°
- Suitable for door sizes 2-6
- Size #2: Door width of 850mm & Weight of 40kg
- Size #3: Door width of 950mm & weight of 60kg
- Size #4: Door width of 1100mm & Weight of 80kg
- Size #5: Door width of 1250mm & Weight of 100kg
- Size #6: Door width of 1400mm & Weight of 120kg
- Finish: Matte Black
- 5 year warranty
- Fire Rated AS1905, As1530

Art. SGDC165-BLK

NEW

'195 Series' DOOR CLOSER - Cam Action - PULL (1-5) *MATTE BLACK*



PRODUCT SPECIFICATION

- Cam Action
- B-Type - Pull side of the door fixing & Push side transom fixing
- Optional Hold open insert
- Mounting hardware
- Adjustable Backcheck
- Simple to read installation instructions
- Closing range 180° - 15°
- Latching speed range 15° - 0°
- Suitable for door sizes 2-5
- Size #2: Door width of 850mm & Weight of 40kg
- Size #3: Door width of 950mm & weight of 60kg
- Size #4: Door width of 1100mm & Weight of 80kg
- Size #5: Door width of 1100mm & Weight of 100kg
- Finish: Matte Black
- 5 year warranty
- Fire Rated AS1905, As1530
- Tested & certified to BS EN 1154:1997

Art. SGDC195-BLK-B

NEW

'195 Series' DOOR CLOSER - Cam Action - PUSH (1-5) *MATTE BLACK*



PRODUCT SPECIFICATION

- Cam Action
- G-Type - Push side of the door fixing & Pull side transom fixing
- Mounting hardware
- Adjustable Backcheck
- Simple to read installation instructions
- Closing range 180° - 15°
- Latching speed range 15° - 0°
- Suitable for door sizes 2-5
- Size #2: Door width of 850mm & Weight of 40kg
- Size #3: Door width of 950mm & weight of 60kg
- Size #4: Door width of 1100mm & Weight of 80kg
- Size #5: Door width of 1100mm & Weight of 100kg
- Finish: Matte Black
- 5 year warranty
- Fire Rated AS1905, As1530
- Tested & certified to BS EN 1154:1997

Art. SGDC195-BLK-G



BLACK RANGE

NEW

DOOR CYLINDERS



6 Pin Cylinders

LOCK CYLINDER (570) OVAL *Matte Black*

PRODUCT DESCRIPTION



LOCKTON 410-BLK, 570 Oval cylinders are a commercial grade 6-pin solid brass cylinder, suitable for locks requiring an Australian oval cylinder

PRODUCT SPECIFICATION

- Made of Solid Brass
- Matte Black Finish
- C4 6-Pin with 2 x Keys (Keyed Versions)
- Cylinder Profile: C4 (LW5)
- Available in KA (Keyed Alike) or KD (Keyed to Differ)
- Suitable for Restricted Inline Key Systems
- Comes with Z,X,W & "Rabbit ear" Cams (the 4 x most common used Cams in Australia)

Art. **410-BLK-KA1**
Art. **410-BLK-KD**

LOCK CYLINDER (201) ROUND (KD) *Matte Black*



PRODUCT DESCRIPTION

LOCKTON 420-BLK, 201 Round cylinders are a commercial grade 6-Pin solid brass cylinder, suitable for locks requiring an Australian 201 Cylinder (like Lockwood 001)

PRODUCT SPECIFICATION

- Made of Solid Brass
- Matte Black Finish
- Configuration: KD (Keyed to Differ)
- C4 6-Pin with 2 x Keys (Keyed Versions)
- Cylinder Profile: C4 (LW5)
- Suitable for Restricted Inline Key Systems
- Supplied with a Large Solid Brass Cylinder Rose

Art. **420-BLK-KD**



WA News South Metropolitan TAFE Official Opening

On Friday evening the 21st of April in Rockingham, Western Australia, we celebrated the official opening of a new, permanent training facility for apprentices.

This new facility has been specifically designed and fitted out for locksmiths.

It represents many years of hard work from numerous people, and also a significant investment by both South Metropolitan TAFE and the Department of Workforce and Development.

The evening was attended by representatives from both the TAFE and industry, and it was co-sponsored by South Metropolitan TAFE, the Master Locksmiths Association of Australasia and the Locksmiths Guild of Australia.

Our industry suppliers also deserve a special mention. A number of them installed some terrific signage in the main training area:

- ASSA ABLOY
- SG LOCK & SECURITY
- LSC
- LOCK & KEY
- SAFE CENTRAL

Our suppliers donate many thousands of dollars worth of products every year, and without their support, the next generation of locksmiths would not have access to the very latest products and equipment.

A big thank you to former Regional Director for Western Australia, Steve Arias. Steve has worked tirelessly for over ten years, often behind the scenes, to get this facility up and running, and I am sure his efforts will be appreciated for many years by future generations of locksmiths.

-Matt Graham
Regional Director for Western Australia



Ian York, SG Lock & Security WA Sales Manager was on site to take part in this WA Industry Event





XK UNIVERSAL REMOTES

- Generic remote designed to be used on Vehicles where the Transponder & Remote programming is separate **RED** packaging for easy identification.
- Accepts KEYDIY key blades.
- Accepts "carbon wedge" transponder chip.
- Accepts the XHORSE Super Chip (see right)

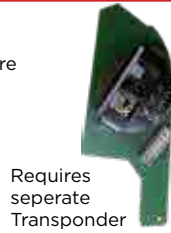

Requires separate Transponder

Wired Generation



XK SERIES (FLIP)

art. **XK-B5-08-BSC** art. **XK-B5-06-BSC** art. **XK-TO-00-BSC** art. **XK-TO-01-BSC** art. **XK-TO-10-BSC** art. **XN-DS-00-BSC** art. **XK-BU-01-BSC**



2 Button



3 Button



3 Button



2 Button



4 Button



3 Button



3 Button + 1

art. **XK-BU-02-BSC** art. **XK-BU-03-BSC** art. **XK-KF-20-BSC** art. **XK-LK-S0-BSC** art. **XK-MQB-1-BSC**



3 Button + 1



3 Button



3 Button + 1



3 Button



3 Button

XK SERIES (FOB)

art. **XK-HY-04-BSC** art. **XK-TO-08-BSC**



3 Button + 1



4 Button + 1

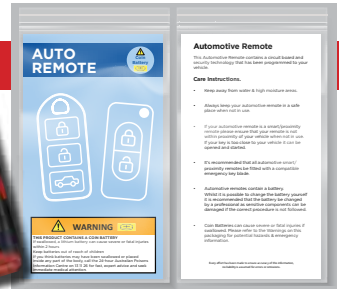

Universal card for each remote with after-care instructions & MAXELL Battery included



XN UNIVERSAL REMOTES

- Designed to be used on Vehicles where the Transponder & Remote are Integrated.
- More specifically for OEM Philips keys that contain a "NXP" eeprom chip like, identify as ID46 series (PCF7941, PCF7945 etc.)
- supplied in **BLUE** packaging for easy identification.
- Accepts KEYDIY key blades
- Battery must be in the remote for Wireless generating.



art. **XN-FO-01-BSC**



3 Button + 1

art. **XN-BU-01-BSC**



3 Button + 1



Wireless Generation

Integrated Transponder (NXP)



XE UNIVERSAL REMOTES

Unique remote designed to be used on both vehicles where the Transponder & Remote programming are separate (XK) & also for Integrated Remote keys (XN). Exact transponder coverage as the super chip, there is No need to add a transponder to this remote. This series is supplied in **PURPLE** packaging for easy identification. Battery must be in the remote for Wireless generating. Accepts KEYDIY key blades.



art.XE-DS-01-BSC



3 Button

art. XE-MQB-1-BSC



3 Button

art. XE-FO-01-BSC



3 Button + 1



Integrated Super Chip Transponder

Wireless Generation



XS UNIVERSAL REMOTES

- The XS Series are a Smart Remote, designed to be used on Vehicles with Smart / Proximity Systems.
- This series is supplied in **ORANGE** packaging for easy identification.
- Full compatibility can be found on our "SRS" Database
- Battery must be in the remote for Wireless generating.



art. XS-KF-01-BSC



2 Button

art. XS-MQB-1-BSC



3 Button

art. XS-CS-00-BSC



2 Button



XM38

INTERNAL COMPONENT

Art. XH-TOY-XM-BSC

'XM' UNIVERSAL SMART KEY FOR LEXUS, SUBARU, TOYOTA VEHICLES

PRODUCT DESCRIPTION:

The XH-TOY-XM is a Universal Smart Remote, designed to be used on Vehicles with Smart / Proximity Systems specifically in TOYOTA/LEXUS & SUBARU

This remote has the ability to lower the stock holdings of SGT or OEM smart remotes - replacing 20 + types of Toyota/Lexus smart keys alone.

The XM-38 PCB has 4 buttons, however these buttons can be configured for different applications using the Key Tool Max. Comes supplied in a 3 Button + Panic shell as standard.

COMPATIBLE WITH:



Art. EB-TOY-30-2 (FULL BLADE)



Art. EB-TOY-HILUX (HALF BLADE)



ANOTHER WORLD **1st**



ORIGINAL
LISHI TOOLS

NEW

LISHI INLINE-L RANGE FOR OPPOSITE HANDED DOORS



PRE-ORDER NOW ON



sglocks.com.au



NEW

C4 Keyway



Domestic Pick - C4 - 5 Pin - (Opposite Handing) *Anti-Glare*

PRODUCT SPECIFICATION

- Lock Profile: C4 LW4
- Compatibility: C4 5 pin Keyway
- Finish: Anti-Glare
- Tool Type: 2-in-1 Pick & Decoder

Art.LP-LW4-L-AG

NEW

C4 Keyway

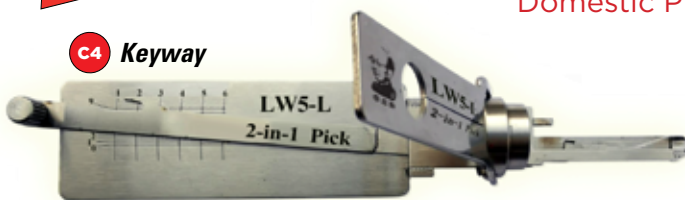

Domestic Pick - C4 - 6 Pin - (Opposite Handing) *Anti-Glare*

PRODUCT SPECIFICATION

- Lock Profile: C4 LW4
- Compatibility: C4 6 pin Keyway
- Finish: Anti-Glare
- Tool Type: 2-in-1 Pick & Decoder

Art.LP-LW5-L-AG

NEW

TE2 Keyway



Domestic Pick - TE2 - 5 Pin - (Opposite Handing) *Anti-Glare*

PRODUCT SPECIFICATION

- Lock Profile: TE2
- Compatibility: TE2 5 pin Keyway
- Finish: Anti-Glare
- Tool Type: 2-in-1 Pick & Decoder

Art.LP-TE2-L-AG



NEW

'Lishi' L-DOMESTIC STARTER KIT - Includes 3 x Most Popular Domestic Lishi Picks - (Opposite Handing)

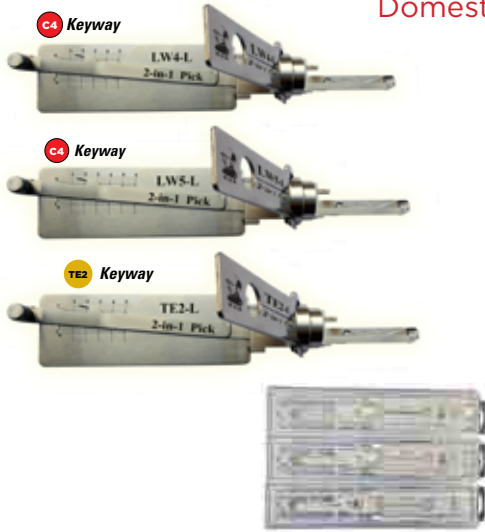

PRODUCT DESCRIPTION

- The LP-KIT-DOM-L-START LISHI Pick Starter Kit, is the ideal kit for anyone getting into domestic LISHI picking and decoding.
- The kit contains 3 x of the most popular domestic pick and decoders, making it perfect for beginners or experienced people.

PRODUCT SPECIFICATION

Kit contains the below individual items.

Art.

- LP-LW5-L-AG
- LP-LW4-L-AG
- LP-TE2-L- AG
- LP-PC

Description

- Domestic Pick - C4 - 6 Pin *Anti-Glare*
- Domestic Pick - C4 - 5 Pin *Anti-Glare*
- Domestic Pick - TE2 - 5 Pin *Anti-Glare*
- LISHI PROTECTIVE CASE

ArtLP-KIT-DOM-L-START

**VERIFY YOUR
ORIGINAL
LISHI TOOLS**



Original Lishi Tools Verification



ORIGINAL LISHI Tools are supplied with a verification code on the back of the pick. This code can be validated to ensure you are trusting your business to;

**SCAN TO VERIFY
YOUR TOOLS NOW**



the Original & the Best :
ORIGINAL LISHI



**Exclusive ORIGINAL LISHI
Distributor for Australia &
New Zealand**

140+ LISHI Picks
Stocked for
Immediate Dispatch



“Back in Black Promo”



LOCKTON
commercial
BLACK RANGE

PROMO 1 ⚡

SPEND OVER \$790.00 * ON

sglocks.com.au

In the one order and receive FREE

LOCKTON T-SHIRT
‘BLACK RANGE’

SIZES: S,M,L,XL,XXL



PROMO 2 ⚡⚡

SPEND OVER \$1290.00 * ON

sglocks.com.au

In the one order and receive FREE

LOCKTON HOODIE
‘BLACK RANGE’

SIZES: S,M,L,XL,XXL



PROMO 3 ⚡⚡⚡

SPEND OVER \$1790.00 * ON

sglocks.com.au

In the one order and receive FREE

T-SHIRT & HOODIE
‘BLACK RANGE’

SIZES: S,M,L,XL,XXL



“MAY/JUNE Promo” valid until 30th JUNE 2023 or whilst stocks last.
* Free Promotion item is only valid for online orders * Pricing shown excludes GST
pricing as of 15/5/2023 and is subject to change. For most accurate pricing please check the sglocks website.



Head Office
PH : 02 9352 0600
FAX: 02 9748 0566

Your Sales Managers:

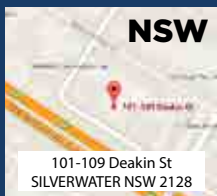

NSW
101-109 Deakin St
SILVERWATER NSW 2128
Colin McFarland
0491 445 005

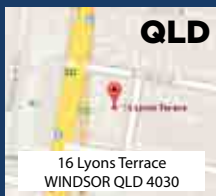

QLD
16 Lyons Terrace
WINDSOR QLD 4030
Vince Carson
0437 770 576

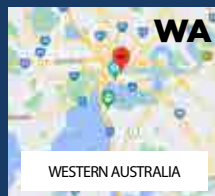

WA
WESTERN AUSTRALIA
Ian York
0472 698 398

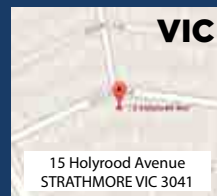

VIC
15 Holyrood Avenue
STRATHMORE VIC 3041
Henry Guldon
0400 613 714



NZ
4 Manu Tapu Drive
Intl Airport, Auckland
NZ Toll Free
0800 00 15 98